

batimet
Holz-Aluminium · Systeme · Fenster · Fassade

Enderstrasse 90 | D-01277 Dresden
Telefon: +49 (0) 351.81186.0
Telefax: +49 (0) 351.81186.11
info@batimet.de | www.batimet.de

System		Datum	Name	Maßstab
batimet TA35 Aufdopplungsprofile Holz IV68 und IV78	Gezeich.	18.09.2018	Pickel	Ansicht -
Beschreibung	Gepr.			Detail -
10 bis 70 mm	Norm			
	Zeichnungs-Nr.: 10001			Index: A

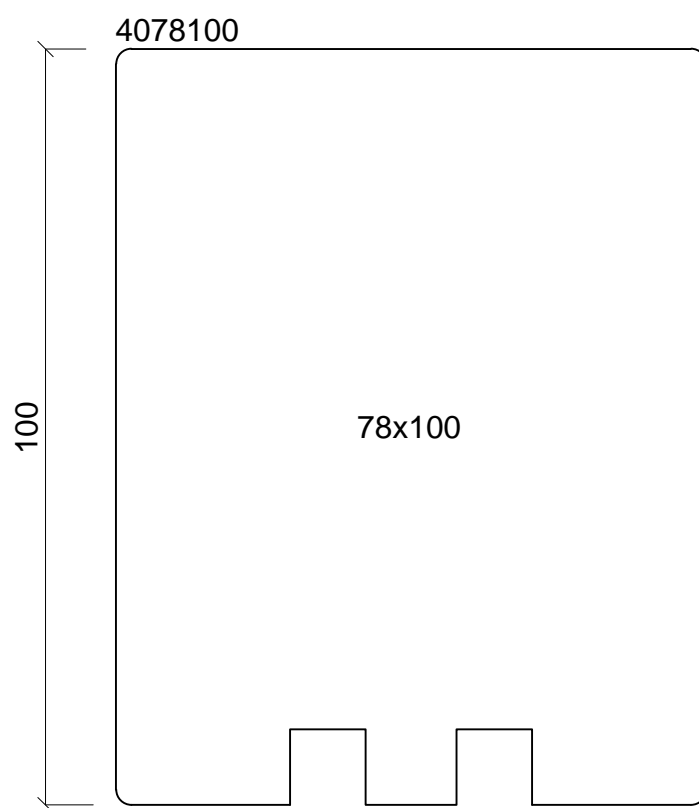
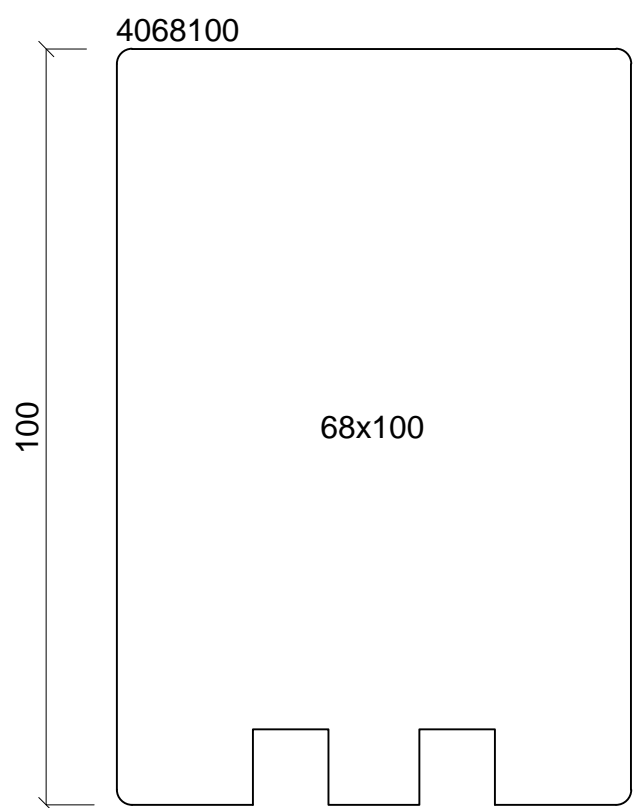
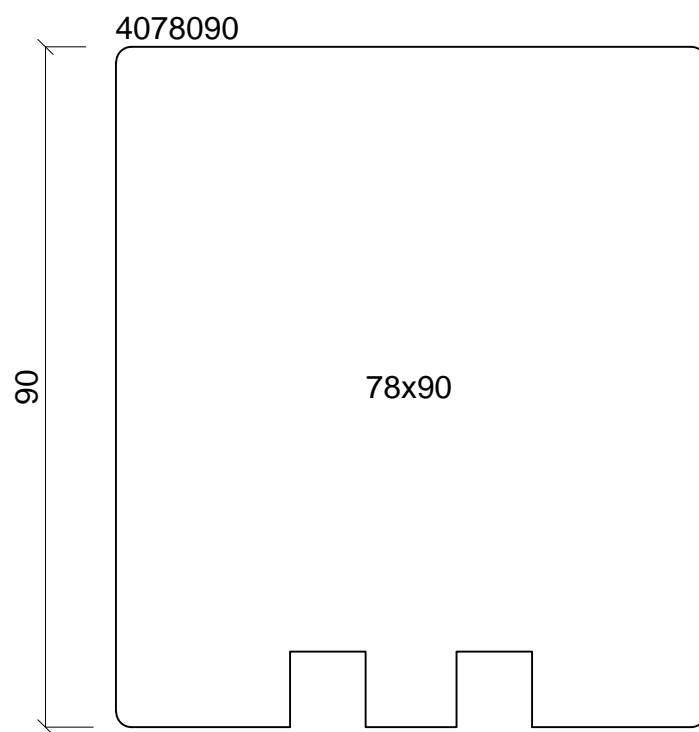
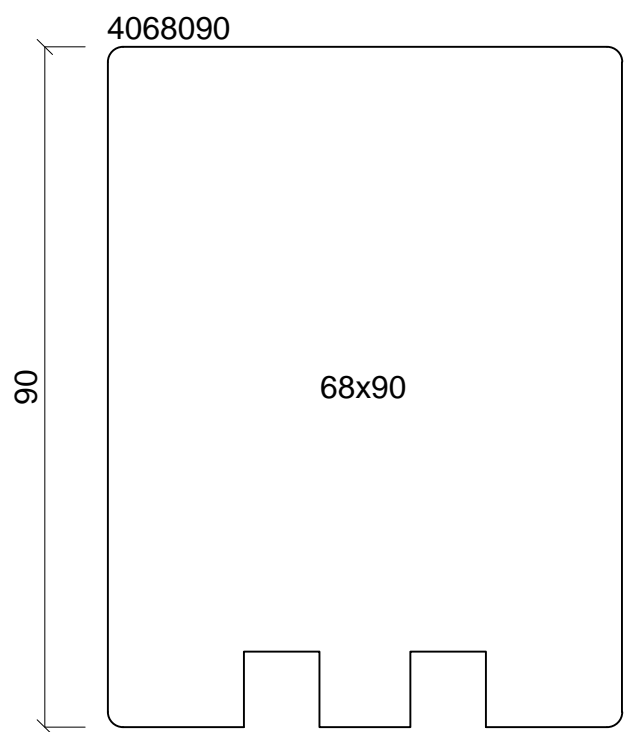
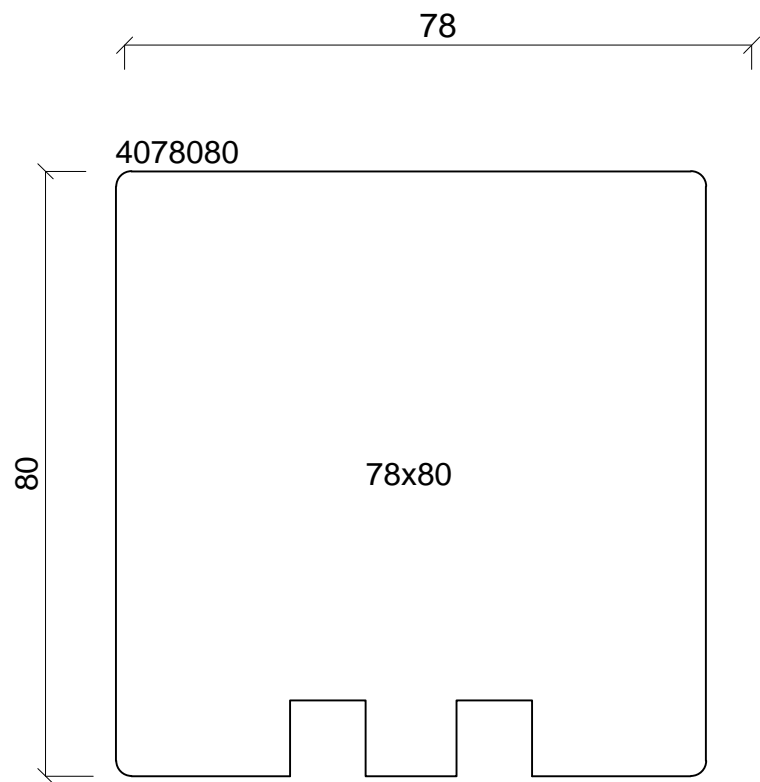
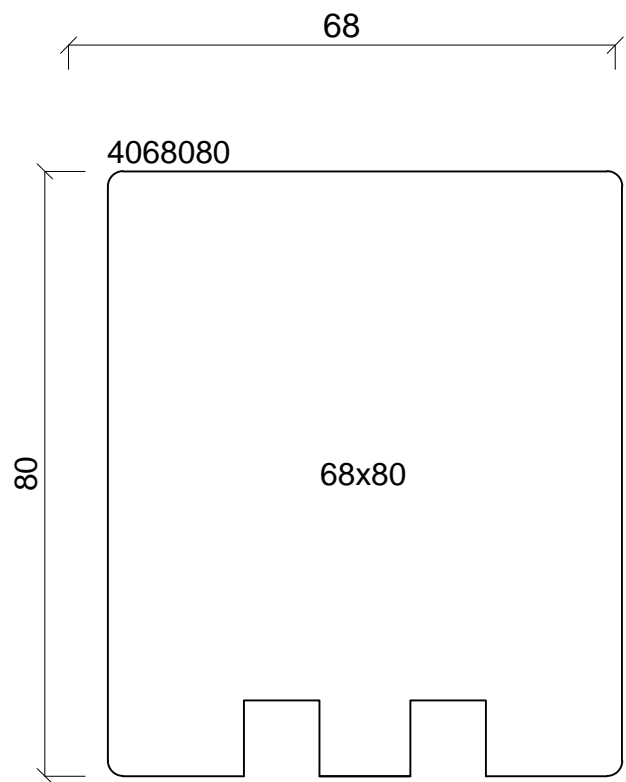

batimet
Holz-Aluminium · Systeme · Fenster · Fassade

Enderstrasse 90 | D-01277 Dresden
Telefon: +49 (0) 351.81186.0
Telefax: +49 (0) 351.81186.11
info@batimet.de | www.batimet.de

System		Datum	Name	Maßstab	
batimet TA35 Aufdopplungsprofile Holz IV68 und IV78	Gezeich.	18.09.2018	Pickel	Ansicht	M1:1
Beschreibung	Gepr.			Detail	-
80 bis 100 mm	Norm				
	Zeichnungs-Nr.:	10002		Index: A	

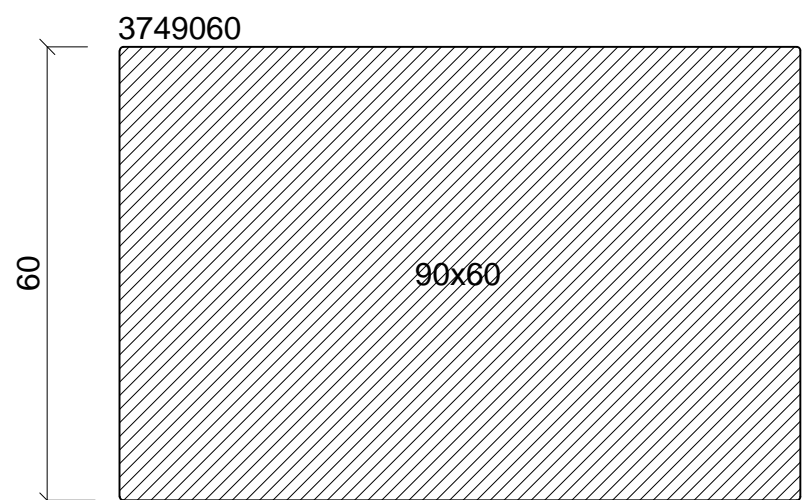
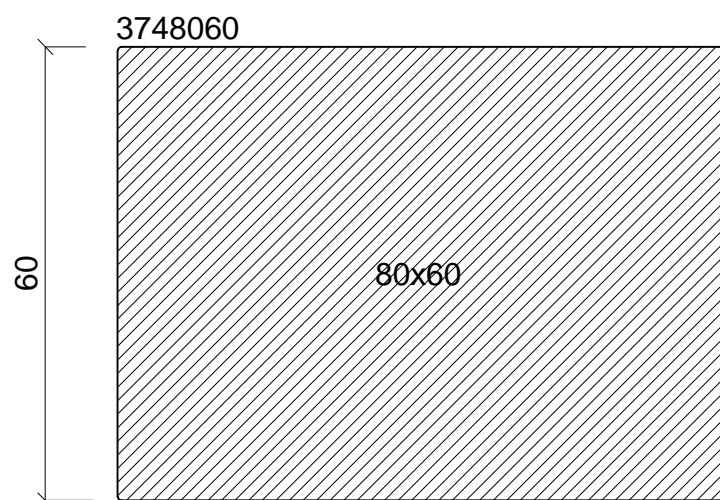
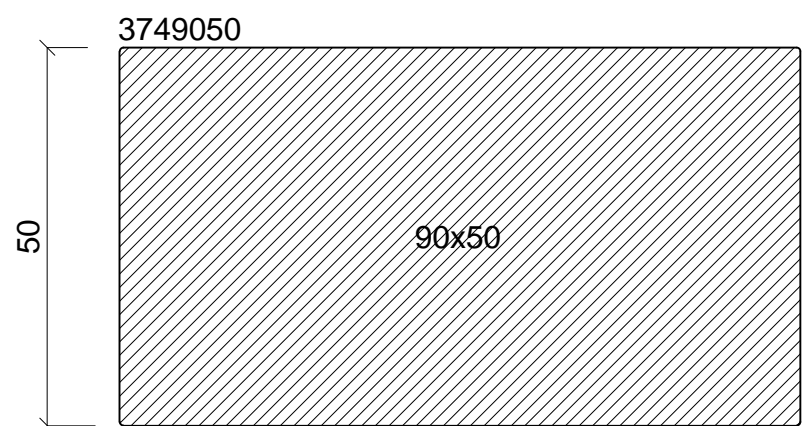
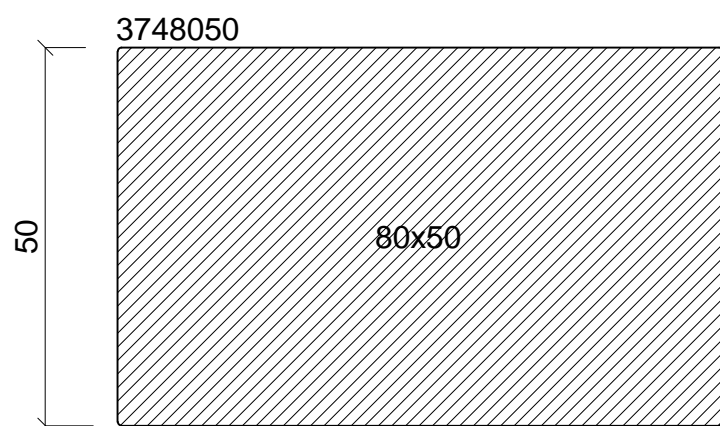
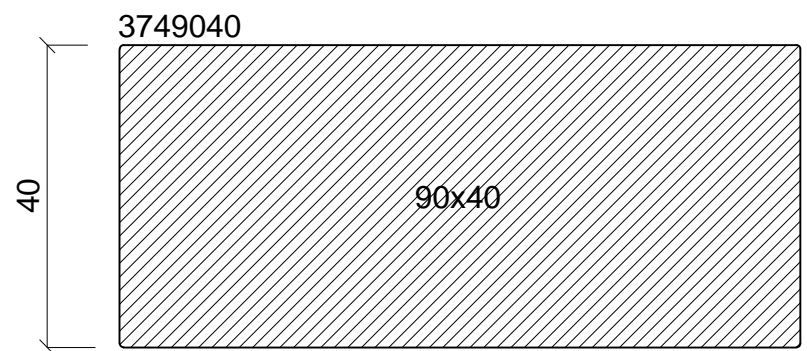
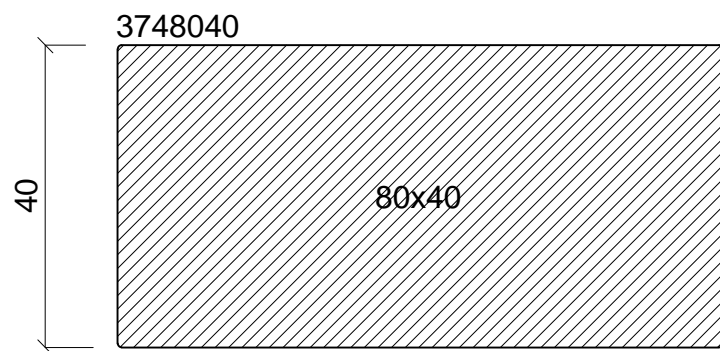
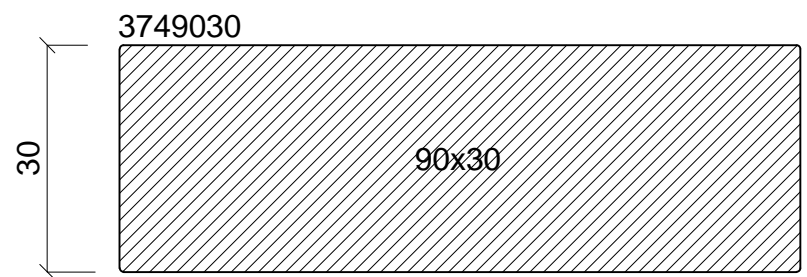
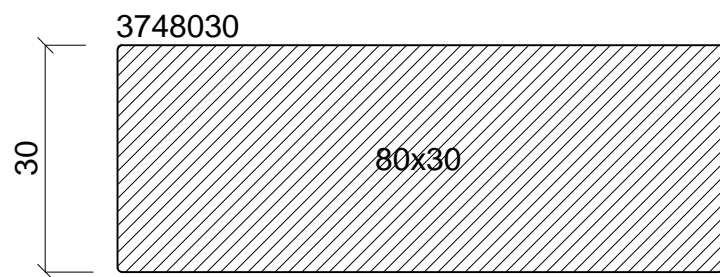
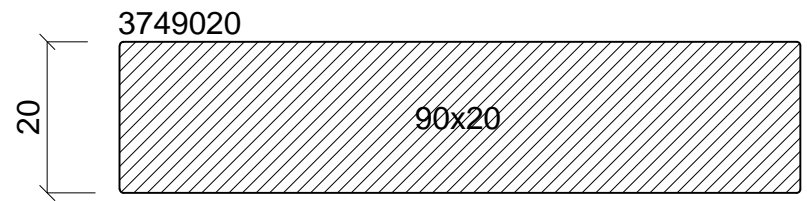
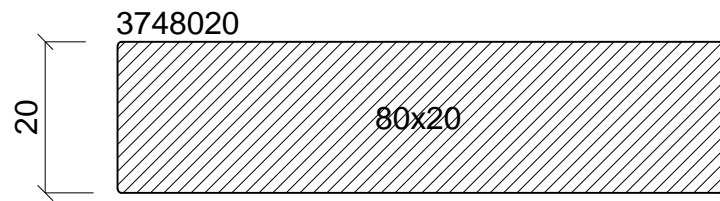
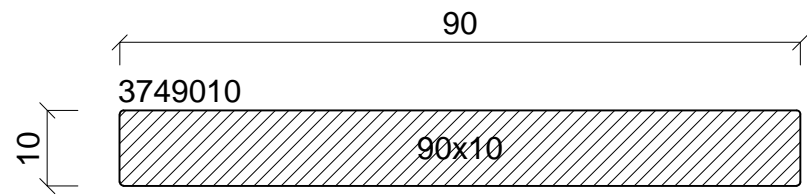
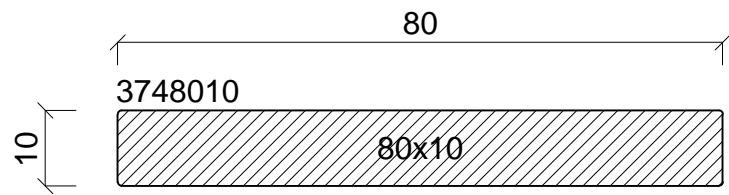

batimet
Holz-Aluminium · Systeme · Fenster · Fassade

Enderstrasse 90 | D-01277 Dresden
Telefon: +49 (0) 351.81186.0
Telefax: +49 (0) 351.81186.11
info@batimet.de | www.batimet.de

System		Datum	Name	Maßstab	
batimet TA35 Aufdopplungsprofile batiblock für IV68 und IV78	Gezeich.	18.09.2018	Pickel	Ansicht	M1:1
	Gepr.			Detail	-
Beschreibung	Norm				
10 bis 60 mm					
	Zeichnungs-Nr.:	10011		Index: A	

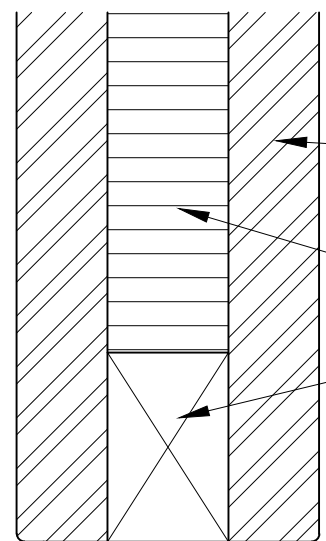
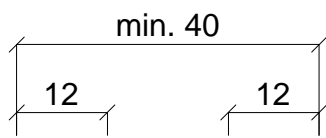

12 mm Sperrholzplatte AW 100,
beidseitig
PUR-Hartschaum, 32 kg/m³
Einleimer Fichte, umlaufend

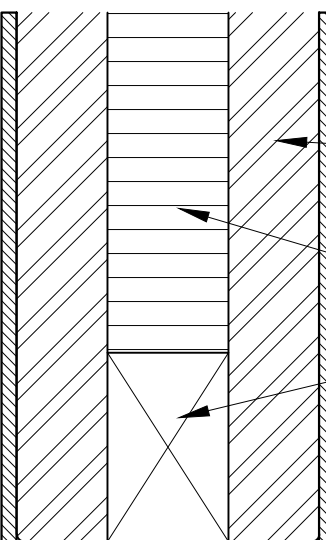
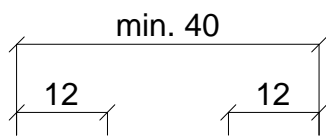
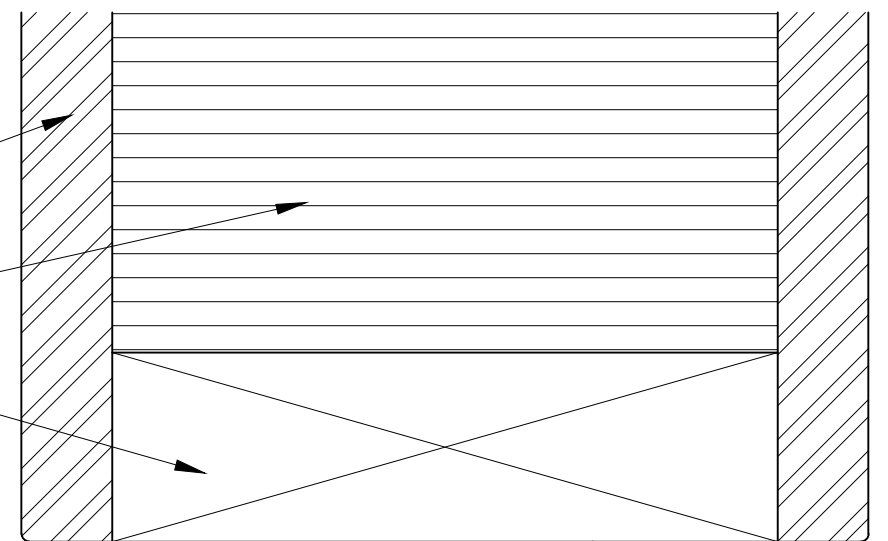
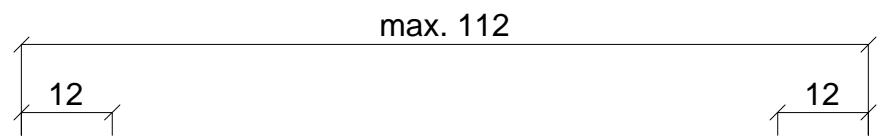

2 mm Aluminiumblech,
beidseitig
12 mm Sperrholzplatte AW 100,
beidseitig
PUR-Hartschaum, 32 kg/m³
Einleimer Fichte, umlaufend

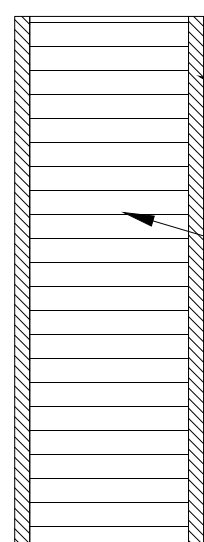
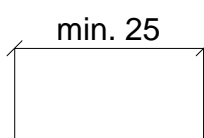
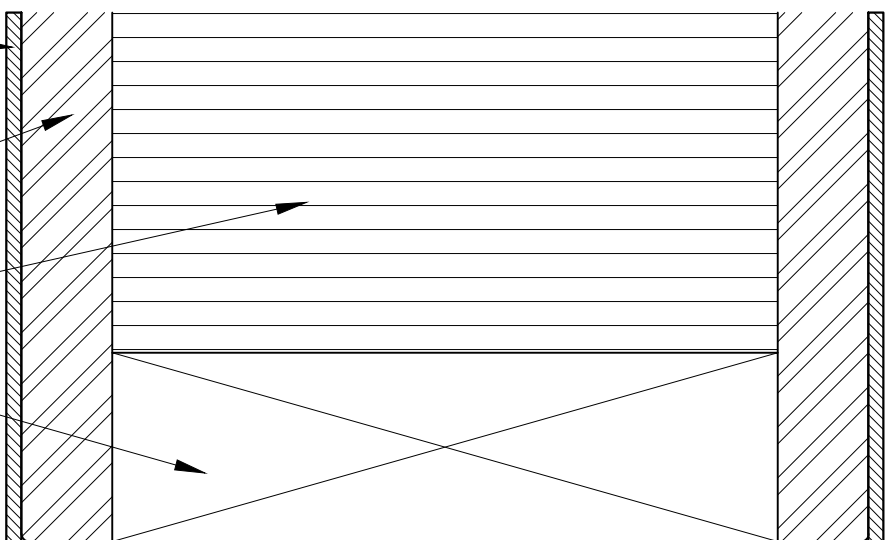
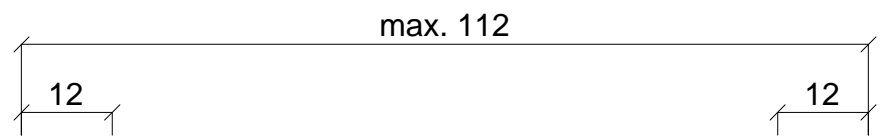

2 mm Aluminiumblech,
beidseitig
PUR-Hartschaum, 32 kg/m³

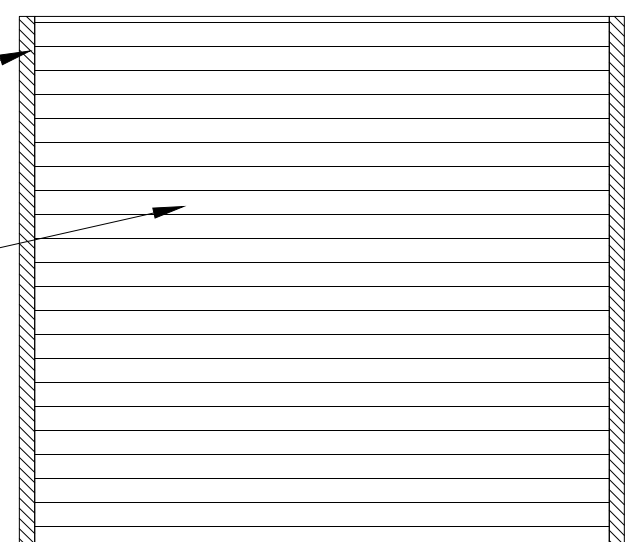
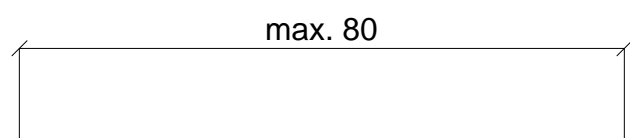

batimet
Holz-Aluminium · Systeme · Fenster · Fassade

Enderstrasse 90 | D-01277 Dresden
Telefon: +49 (0) 351.81186.0
Telefax: +49 (0) 351.81186.11
info@batimet.de | www.batimet.de

System		Datum	Name	Maßstab
batimet TA35 Paneelaufbauten	Gezeich.	18.09.2018	Pickel	Ansicht M1:1
	Gepr.			Detail -
Beschreibung	Norm			
verschiedene Stärken				
	Zeichnungs-Nr.: 10012			Index: A